

Cavity Fire Closers

A barrier that prevents fire escaping from or entering into the external wall cavity around openings.



Installation Guidelines

PRODUCT

The AIM Cavity Closer has been designed to close cavities for fire, thermal and acoustic purposes; it reduces cold bridging when closing cavities at door and window frames.

PHYSICAL INFORMATION

- Thermal Conductivity: $\lambda = 0.034\text{W/mK}$
- Global warming potential = zero
- Rockwool stone wool insulation
- Length: 1200mm
- Common widths: 100, 150, 190mm
- Thickness: 20, 50, 65, 75, 100mm – bespoke sizes available on request.
- DPC Length: 1300mm
- DPC Side overlap: 40mm
- DPC End Overlap: 100mm
- Non-standard sizes and DPC offsets are available.
- Cavity Closers are for use in cavities up to 100mm (for 100mm+ use the AIM Wall Cavity Barrier with a DPC)
- The AIM Cavity Fire Closer has been tested vertically and horizontally to BS EN 1366-4.
- AIM Cavity Fire Closers are installed under compression (5% compression required)

STORAGE

Products are supplied in cartons on wooden pallets with edge protection and a shower proof hood. Orders can be supplied without cartons on request.

Products should be stored away from the elements until ready for installation.

HEALTH & SAFETY

Insulation products supplied by AIM are considered to be inert articles and as such are exempt from requirements to provide a Safety Data Sheet.

A safety handling information sheet is available upon request.

COMPONENTS available from AIM

- Barrier
- Fixing Clips
- Acrylic fire rated intumescent mastic (optional extra)

ITEMS REQUIRED FOR INSTALLATION

- PPE abrasion resistant gloves
- PPE impact resistant goggles
- RPE dust mask
- Drill
- Screwdriver
- Tape measure

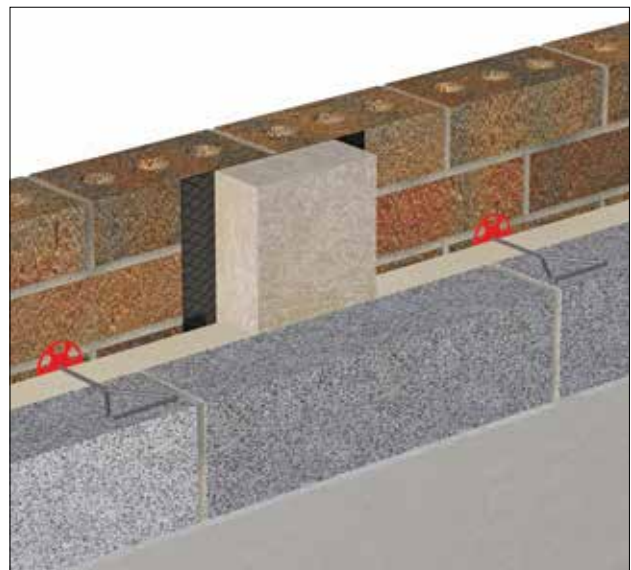

INSTALLATION GUIDELINES



Check that the Cavity Closer is the correct size for the cavity. The Closer should be 5% larger than the cavity.

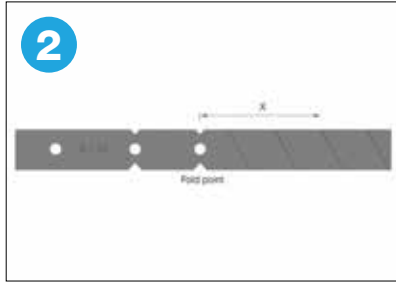

Snap the fixing clips to the correct length. Dimension 'X' should be 50% to 75% of the Closer's thickness.

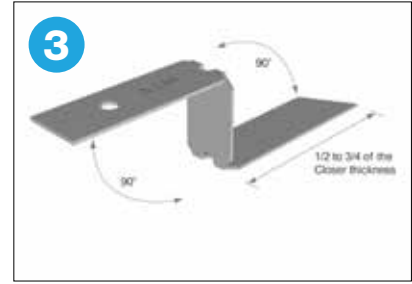

Typical installations will require the clips to be formed to a Z shape.

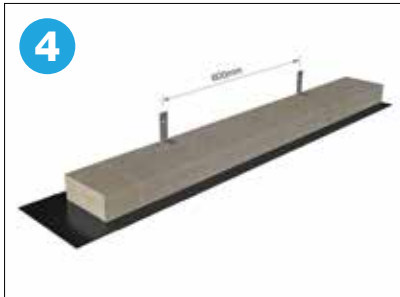

Insert the fixing clips into the barrier approximately 300mm from each end at maximum 600mm centres.



Fit the Cavity Closer into the cavity. Ensure the DPC tail points downwards.



Secure the fixing clips to the internal substrate using a non-combustible and corrosion resistant fixing.



When installing more than one Closer, please ensure that the DPC tail overlaps the lower closer to ensure no moisture can reach the Closer.

Always ensure joints are tight and secure.



Check for any gaps between the Closer and substrates. All gaps should be fully sealed with the fire rated intumescent mastic.

MAINTENANCE

This product does not contain moving parts and, if undisturbed in the cavity, requires no routine inspections or maintenance.

It is recommended that the integrity of the barrier is rechecked if further works are carried out that may have involved disturbing the product.