

# Horizontal Fire Closer

A barrier that prevents the vertical passage of fire and sound in external wall cavities.

## Installation Guidelines

### PRODUCT

The AIM Horizontal Fire Closer is semi rigid Rockwool stone wool insulation laminated to a polythene DPC. It has been designed to provide up to two hours resistance to the spread of fire within a cavity that is adjacent separating floors within multi story buildings. It also significantly reduces flanking sound transmission within external wall cavities.

### PHYSICAL INFORMATION

- Thermal Conductivity:  $\lambda = 0.034\text{W/mK}$
- Complies with Part E of the Building Regulations
- Fire resistance performance of up to 2 hours' insulation and integrity when installed with clips
- Global warming potential = zero
- Rockwool stone wool insulation
- Length: 1200mm
- Width: 260mm – bespoke widths available upon request.
- Thickness: 50, 65, 75, 90, 100 – bespoke thicknesses available on request.
- DPC Polythene
- DPC Length: 1300mm
- DPC Width: 600mm
- DPC Overlaps: Top – 300mm, Bottom – 40mm, End – 100mm
- The Rockwool insulation used for the Horizontal Closer, is pre-compressed to enable it to take up any minor irregularities in the substrates.

### STORAGE

Products are supplied in cartons on wooden pallets with edge protection and a shower proof hood. Orders can be supplied without cartons on request.

Products should be stored away from the elements until ready for installation.

### HEALTH & SAFETY

Insulation products supplied by AIM are considered to be inert articles and as such are exempt from requirements to provide a Safety Data Sheet.

### COMPONENTS available from AIM

- Barrier
- Fixing Clips
- Acrylic fire rated intumescent mastic (optional extra)

### ITEMS REQUIRED FOR INSTALLATION

- PPE abrasion resistant gloves
- PPE impact resistant goggles
- RPE dust mask
- Drill
- Screwdriver
- Tape measure

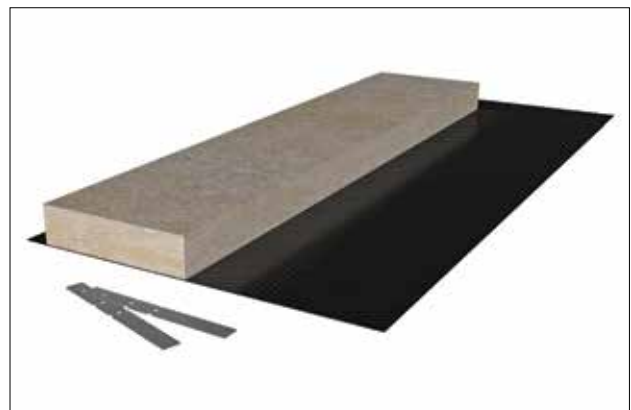

## INSTALLATION GUIDELINES

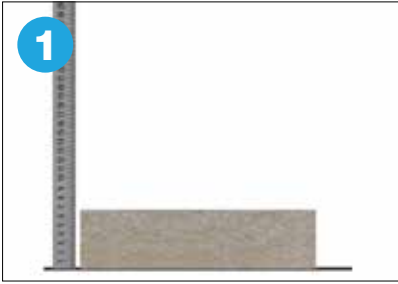

Check that the Horizontal Fire Closer is the correct thickness for the cavity. The Closer should be 5% larger than the cavity.

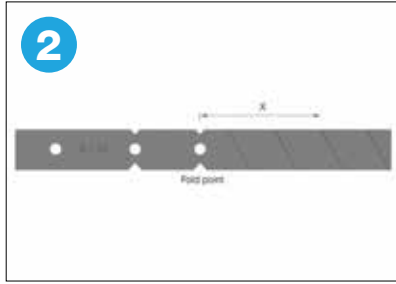

Snap the clips to the correct length. Dimension 'X' should be 50% to 75% of the Horizontal Fire Closer's thickness.

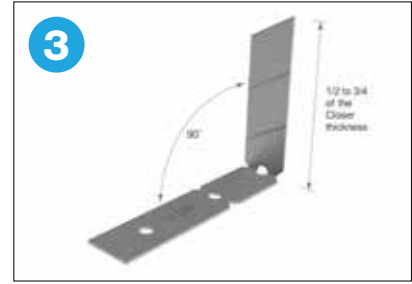

Fold the fixing clips at 90° to form an 'L' shape.



Fasten the clips to the substrate using non-combustible and corrosion resistant fixings at 600mm centres.



Impail the Horizontal Fire Closer onto the fixing clips ensuring the DPC faces away from the internal structure. Ensure the 300mm DPC overlap is above the line of the closer.



If the Horizontal Fire Closer is being fitted against a sheathing board, dress the 300mm DPC overlap behind the breather membrane.



If the Horizontal Fire Closer is being used in a traditional brick cavity the 300mm tail can be dressed into a mortar joint.

## MAINTENANCE

This product does not contain moving parts and, if undisturbed in the cavity, requires no routine inspections or maintenance. It is recommended that the integrity of the barrier is rechecked if further works are carried out, which may involve disturbing the product.